

1270504 Change and Inspection of the Rotor Belt HERU® S and T – Next Generation

Article number belt

1220003	V-belt 320 HERU	HERU 100 S / HERU 100 T
1220006	V-belt 405 HERU	HERU 160 S / HERU 160 T
1220005	V-belt 515 HERU	HERU 200 / 300 (S and T)



Warning! Turn off the power before starting the maintenance.



Warning! Sharp edges, use protection gloves.

Open the lid and remove the Rotor Package on HERU S

1. Remove plastic cover. View A.
2. Remove the Lid, four screws, quarter turn lock. View B.
3. Disconnect the Rotor Package cable (1). View C.
4. Pull out the Rotor Package, use protection gloves.

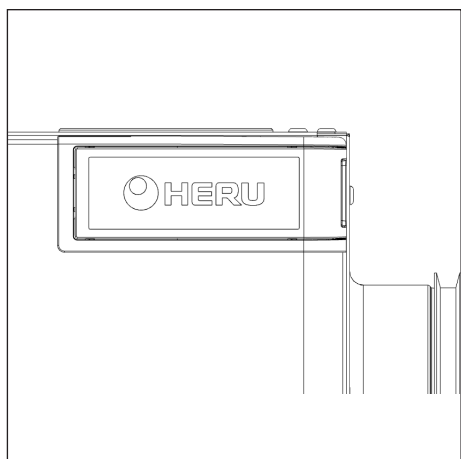

View A – Lid bolt cover.

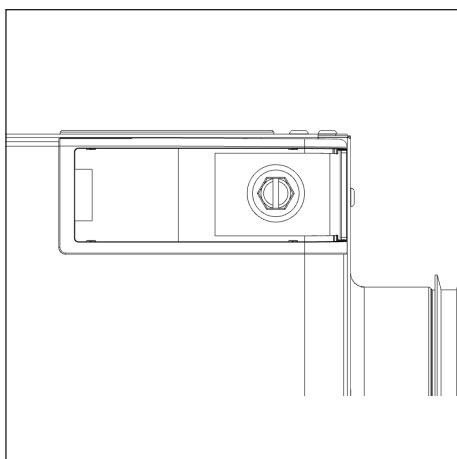

View B – Lid bolts.

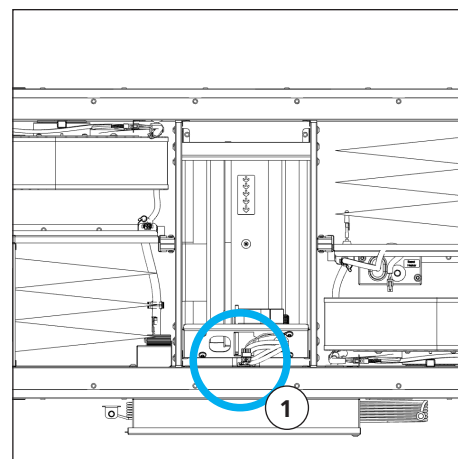

View C – Disconnect Rotor Package cable.

Open doors and remove the Rotor Package on HERU T

1. Open door lock (2) with a screwdriver, quarter turn lock. View D.
2. Disconnect the Rotor Package cable (3). View E.
3. Pull out the Rotor Package, use protection gloves.

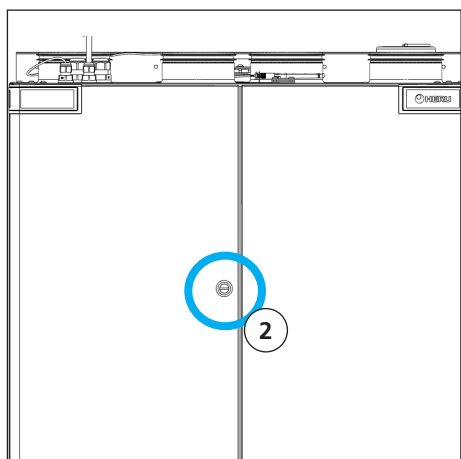

View D – Door lock.

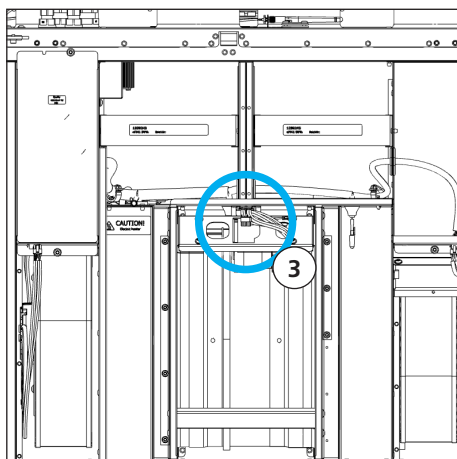

View E – Disconnect Rotor Package cable.

Disassemble of Rotor Package of Heru S/T

1. To be able to change the belt, one gable end must be removed. View F.
2. Remove the gable (4) facing the pulley on the rotor motor. View F.
3. Unscrew eight bolts – Torx T25x10 (5) holding the gable and one center bolt holding the brush console – Allen Hex M8x20 (6). View G.
4. Remove the gable (4) and brush console (7). View H.
5. Remove the belt (8). View H and I.
6. Assemble back in reverse order.
7. Close and secure doors (HERU T) or screw back lid (HERU S). View B and D.

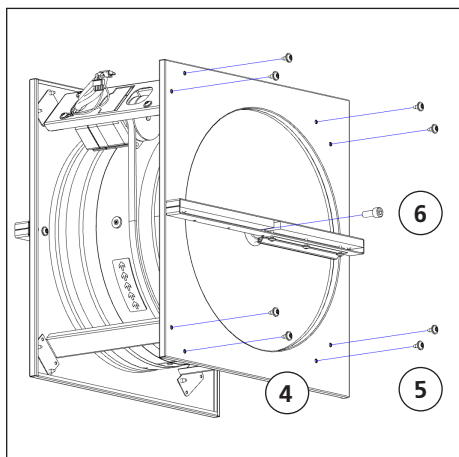

View F – Unscrew bolts.

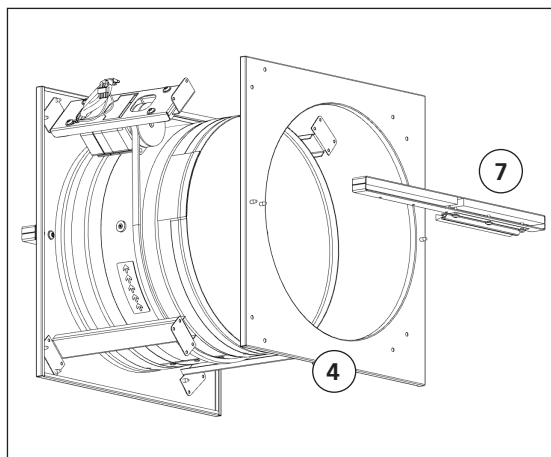

View G – Loose gable and brush console.

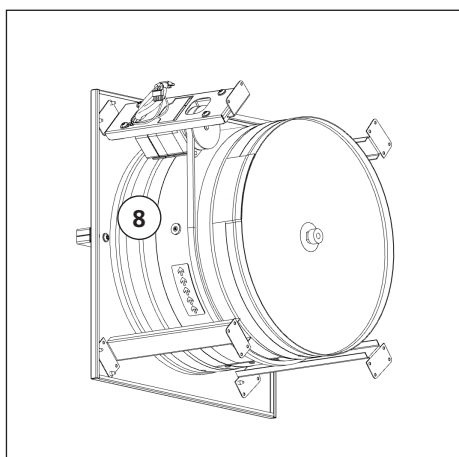

View H – Stripped Rotor Package.

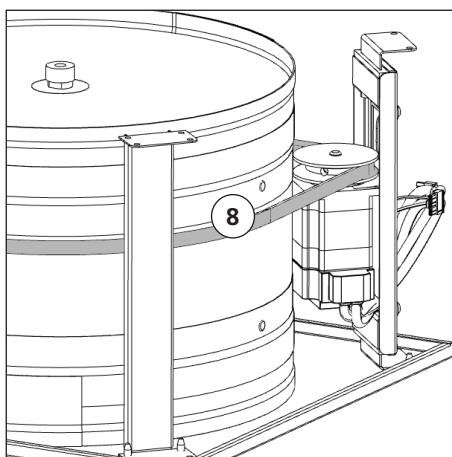

View I – Rotor motor with belt (shaded).

Inspection of the rotor belt

1. The belt (8) can be inspected without any disassembly of the rotor package.
2. Check the belt (8) for flaws and cracks. View J.
3. Turn the rotor (9) by hand to be able to check the hole length of the belt (8). Check all sides of the belt.

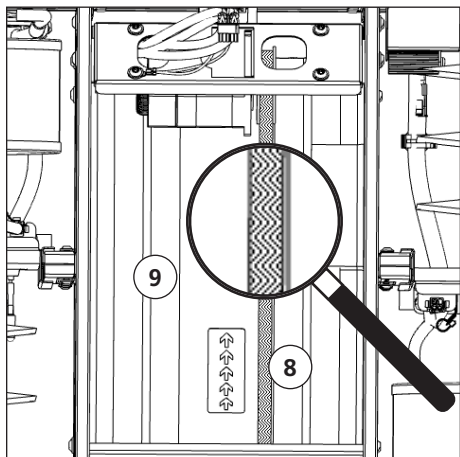

View J – Check the belt. Picture shows Heru S.

1270504 Byte och inspektion av rotorrem HERU® S och T – Next Generation

Artikelnummer drivrem

1220003 Kilrem 320 HERU HERU 100 S / HERU 100 T

1220006 Kilrem 405 HERU HERU 160 S / HERU 160 T

1220005 Kilrem 515 HERU HERU 200 / 300 (S och T)



Varning! Se alltid till att bryta huvudströmmen innan arbete på utrustningen sker.



Varning! Vassa kanter, använd skyddshandskar.

Öppna locket och ta ur rotorpaketet på HERU S

1. Ta bort plastskyddet. Vy A.
2. Skruva ur de fyra skruvarna med skruvmejsel, kvartvarvslås. Vy B.
3. Koppla loss kabeln till rotorpaketet (1). Vy C.
4. Dra ut rotorpaketet, använd skyddshandskar.

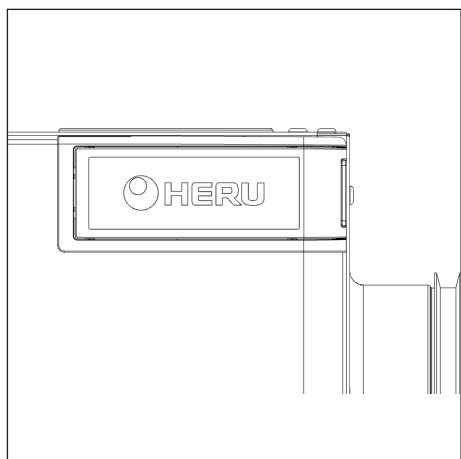

Vy A – Plastskydd.

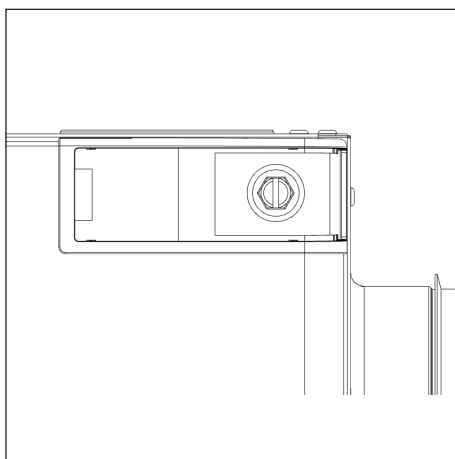

Vy B – Bult för locket.

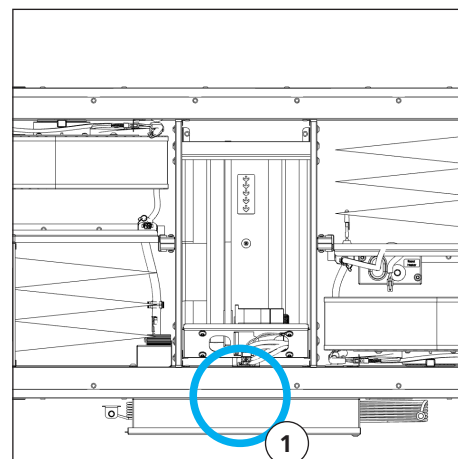

Vy C – Koppla loss kabeln till rotorpaketet.

Öppna dörrarna och ta ur rotorpaketet på HERU T

1. Öppna dörrarna (2) med en skruvmejsel, kvartvarvslås. Vy D.
2. Koppla loss kabeln till rotorpaketet (3). Vy E.
3. Dra ut rotorpaketet, använd skyddshandskar.

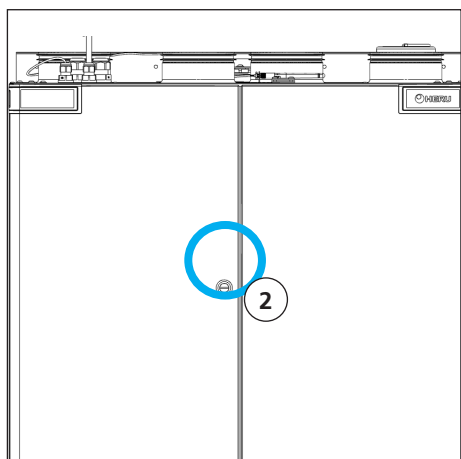

Vy D – Dörrlås.

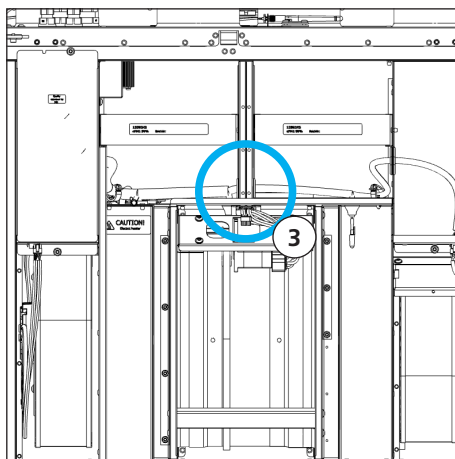

Vy E – Koppla loss kabeln till rotorpaketet.

Skruva isär rotorpaketet för Heru S/T

1. För att kunna byta remmen, måste en gavel skruvas bort. Vy F.
2. Ta bort den gavel (4) som är mot remskivan på rotormotorn. Vy F.
3. Skruva ur 8 skruvar – Torx T25x10 (5) som håller gaveln och en centrumskruv som håller borstlisten – Insex M8x20 (6). Vy G.
4. Ta bort gavel (4 och borstlist)(7). Vy H.
5. Ta bort remmen (8). Vy H och I.
6. Montera tillbaka i omvänd ordning.
7. Stäng och säkra dörrarna (HERU T) eller skruva tillbaka locket på (HERU S). Vy B och D.

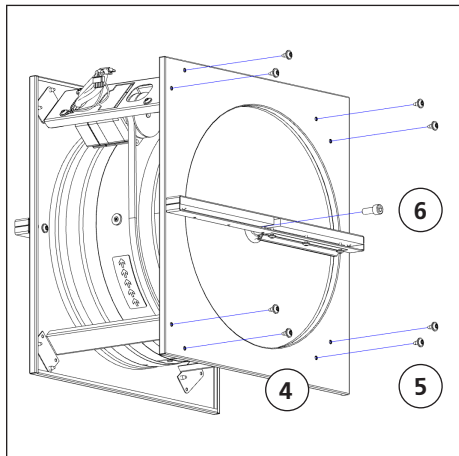

Vy F – Skruva ur skruvarna.

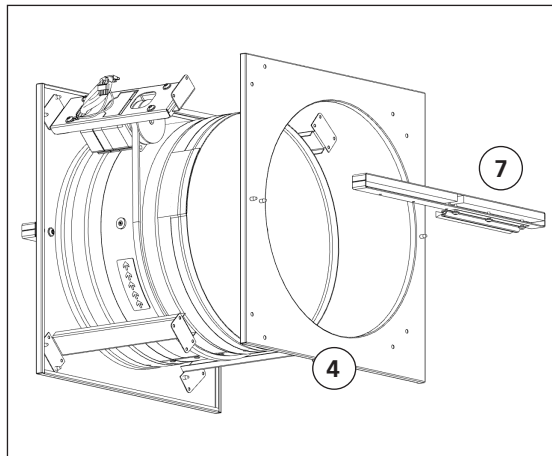

Vy G – Ta bort gavel och borstlist.

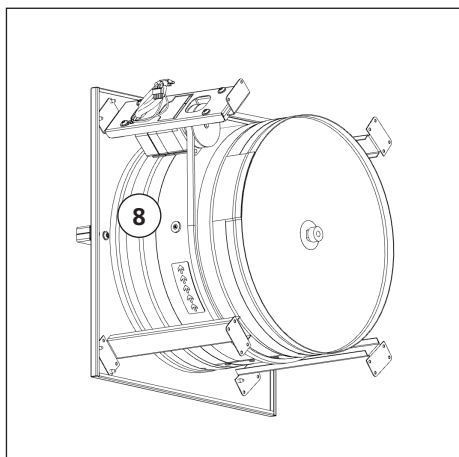

Vy H – Isärtaget rotorpaket.

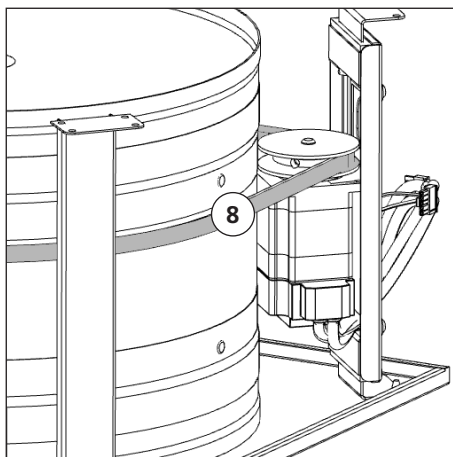

Vy I – Rotormotor med drivrem (skuggad).

Inspektera remmens kondition

1. Remmen (8) kan kontrolleras utan isärmontering. Vy J.
2. Kontrollera remmen (8) så att den inte har några skador eller sprickor. Vy J.
3. Snurra rotorn (9) för hand, för att kontrollera remmens (8) fulla längd, kontrollera alla sidor på remmen.

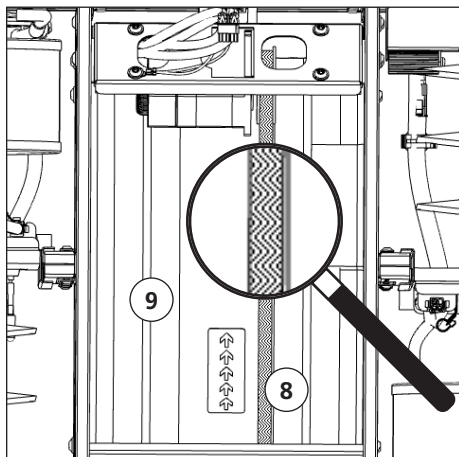

View J – Check the belt. Picture shows Heru S.