

# Replacing the rotor motor package HERU® 50/90 LP



Warning! If the unit is ceiling mounted the rotor falls out when screws are removed.



Always disconnect the power and make sure the power can not be accidentally reconnected before opening or working on the unit.

Open the lid by removing the two screws with a screwdriver PH2.

1. Showing rotor package and rotor motor housing
2. Disconnect plug and remove ground wire screw. View A.
3. Remove both screws to release the rotor package. Pull out the rotor package. View A.
4. Remove 7 screws, six on the side of the rotor package and one next to the rotor motor housing. (Philips PH2). View B.
5. Turn the rotor package so that the rotor motor housing faces downwards. Remove 7 screws, four on the side of the rotor package and three facing the bottom (Philips PH2). View C.
6. Remove the center screw in the middle of the rotor – M8x20 hexagon socket screw, Allen key 6 mm.
7. Disassemble the rotor package. View D.
8. Lift and remove the old rotor motor package and replace it with the new module. Reassemble the rotor package as above in reverse order. View E.
9. Note! Make sure the rotor seal and distance are fitted correctly when reassembling the rotor package.
10. Adjusting the rotor drive: Remove the rubber seal next to the rotor motor housing. Adjust the friction force using the adjustment screw. Clockwise to increase, counterclockwise to decrease. From the point of engagement adjust additionally 3-4 turns clockwise. This can be adjusted while the unit is running. View F.

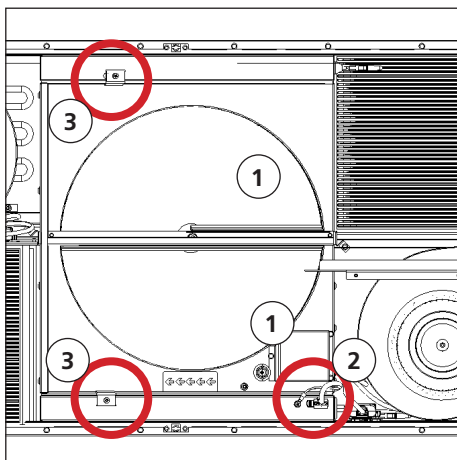

View A – Without the lid

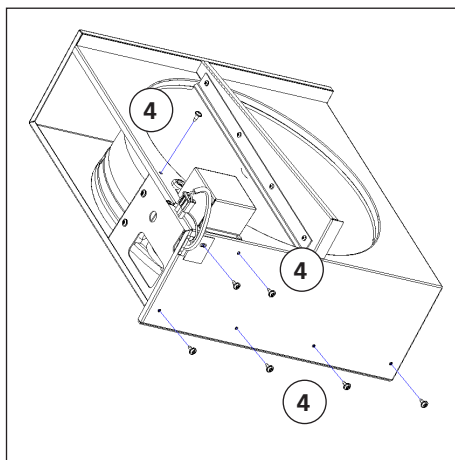

View B

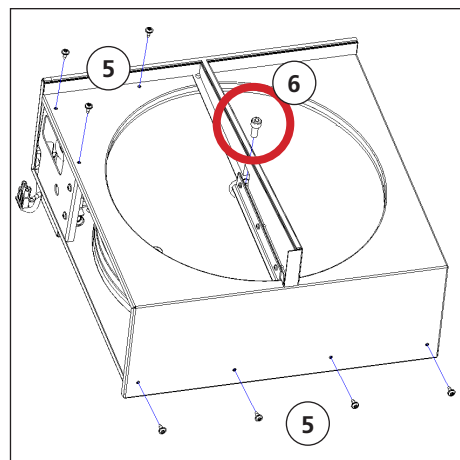

View C

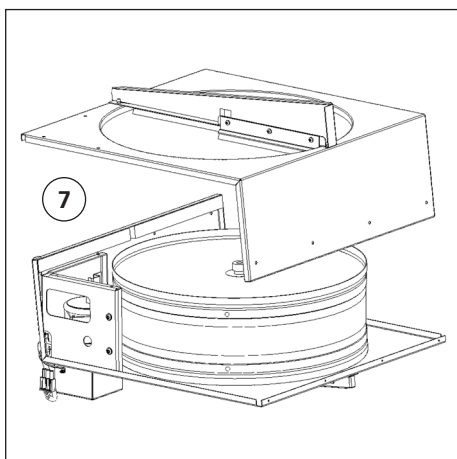

View D

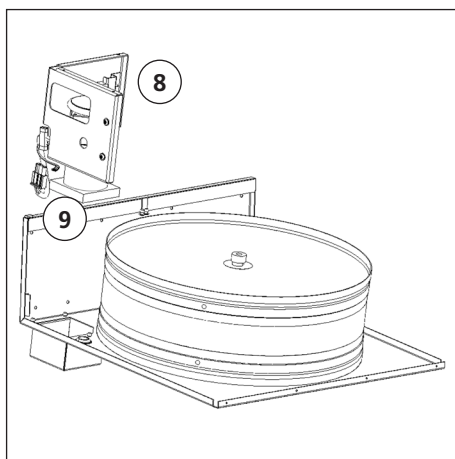

View E

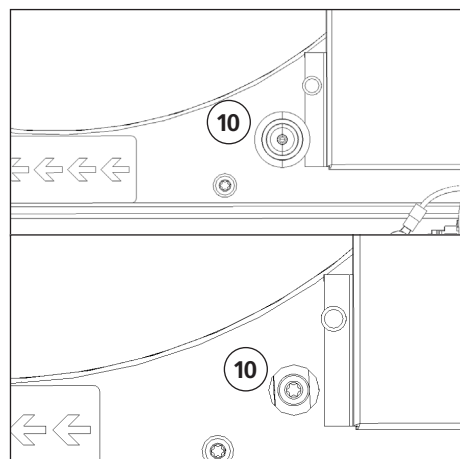

View F

# Byte av rotormotorpaket HERU® 50/90 LP



OBS! Beakta att rotorpaketet ramlar ner när skruvarna lossas om aggregatet är takmonterat.



Bryt alltid strömmen och säkerställ att den ej kan kopplas in.

Öppna locket genom att skruva ur de två skruvarna (skruvmejsel PH2).

1. Rotorpaket och rotormotorhuset
2. Ta isär snabbkontakten för rotormotorn och skruva ur skruven för jordkabeln. Vy A.
3. Lossa båda skruvarna för att lösgöra rotorpaketet, dra ur hela paketet. Vy A.
4. Lossa sju skruvar, sex stycken på gaveln och en intill motorhuset (Philips PH2). Vy B.
5. Vänd på rotorpaketet med rotormotorhuset nedåt. Skruva ur totalt 7 skruvar, fyra st på gaveln och tre st på bottenplattan (Philips PH2). Vy C.
6. Skruva ur centruskruven i rotorns mitt – insexskruv M8x20, 6 mm insexnyckel.
7. Ta isär hela paketet. Vy D.
8. Lyft ur rotormotorpaketet och ersätt med ny modul. Montera sedan ihop hela rotorpaketet igen i omvänd ordning. Vy E.
9. OBS! Se till att rotorns släptätning och rotordistans sitter rätt vid återmonteringen.
10. Justering av rotordrift: Ta bort gummitätningen intill motorhuset. Ställ in anliggningsstrycket med justerskruven, medurs ökar trycket, moturs minskar trycket. När remskivan börjar driva, justera medurs ca 3-4 varv till på justerskruven! Kan justeras under drift. Vy F.

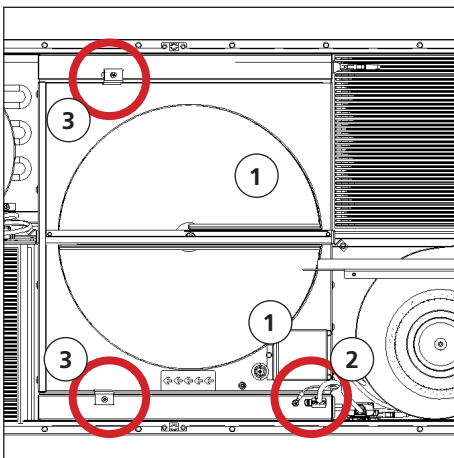

Vy A – utan lock

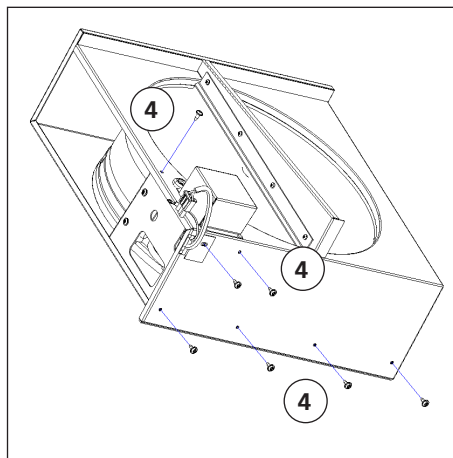

Vy B

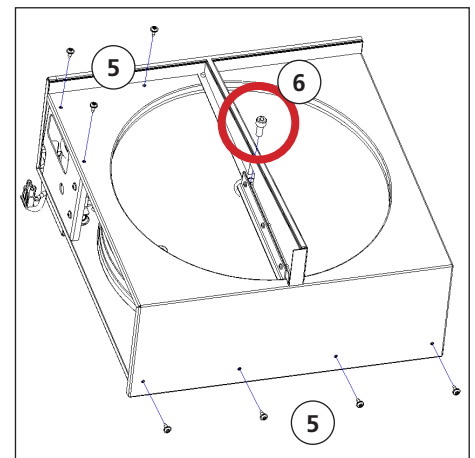

Vy C

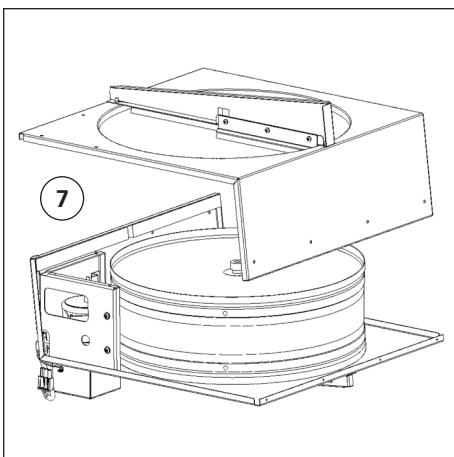

Vy D

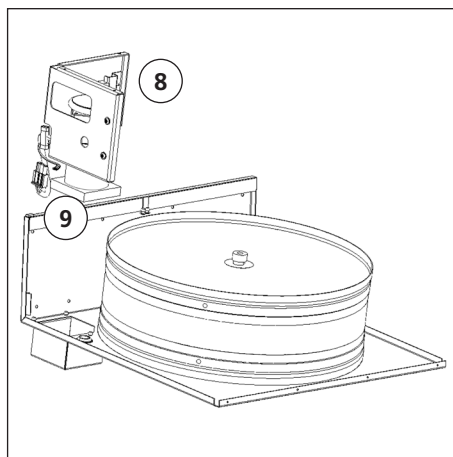

Vy E

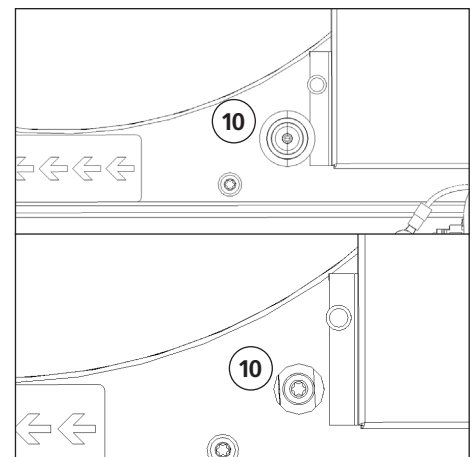

Vy F